



Hardie™ Oblique™  
Cladding 200mm

Hardie™ Oblique™  
Cladding 300mm

**NEW**

# Hardie™ Oblique™ Cladding

The bold, vertical look built your way

Hardie™ Oblique™ Cladding evokes a striking, contemporary aesthetic with wide grooves and bespoke design flexibility.



# A fresh slant on modern home design

**NEW Hardie™ Oblique™ Cladding** delivers a bold modern look through its wide grooves and angled edges. It is the only Hardie™ exterior cladding product with a slanted groove edge that mixes shadows and highlights providing interest and depth.

Available in 200mm and 300mm widths, these 14mm thick shiplap boards offer design flexibility with multiple installation options that result in bold, one-of-a-kind façades.

Similar in appearance to standing seam metal cladding, it's a durable and easy to install premium fibre cement alternative.



Scan here to learn more about Hardie™ Oblique™ Cladding



## Key features

### GROOVES



23mm wide and 6mm deep, with the option to place the oblique edge to the left or right.

### HIGHLIGHTS



When oriented northwards the slanted edge creates depth and elevation.

### WIDTH



200mm or 300mm wide, with 175mm or 275mm groove spacing.

### COLOUR



Supplied primed for the paint colour of your choice.

### VERSATILITY



Install vertically or horizontally, re-clad existing homes or use from the ground up for a new build or extension.

### INNOVATION



Our innovative castellated batten method makes vertical installation and bespoke arrangements easy.



# Product details and specifications

Hardie™ Oblique™ Cladding system offers an uncomplicated cladding solution for modern builds.

<b>Hardie™ Castellated Battens</b>	<ul style="list-style-type: none"> <li>A horizontal batten that allows for drainage and air flow. It's a cost-effective and simple way for vertical installation. The two board widths can be mixed and matched for bespoke groove spacing arrangements.</li> </ul>
<b>Simple installation</b>	<ul style="list-style-type: none"> <li>No need for specialist installers, reducing the number of trades on site.</li> </ul>
<b>Reduce wastage</b>	<ul style="list-style-type: none"> <li>When installed vertically, the 2750mm length boards suit common wall heights which can help to minimise cutting, joining and wastage.</li> </ul>
<b>Hardie™ premium fibre cement</b>	<ul style="list-style-type: none"> <li>Made with durable Hardie™ fibre cement. Not only rot and impact resistant, it is also resistant to moisture damage, is deemed non-combustible and adheres to Bushfire Attack Level (BAL) requirement up to BAL40.</li> </ul>



**Easy to install**

No need for specialist trades reducing complexity and trades onsite



**Easy to paint**

Comes pre-primed and ready to paint



**Cost effective**

Horizontal castellated battens simplify vertical installation



**Fire resistant**

Can be used as part of Hardie™ Smart Fire and Acoustic Wall System with a fire resistance level (FRL) of up to 60 minutes



**Year warranty**

25 year product warranty



**Compliance**

CodeMark certified

PRODUCT CODE	LENGTH	WIDTH	THICKNESS
405301	4200 mm	200 mm	14 mm
405303	4200 mm	300 mm	14 mm
405300	2750 mm	200 mm	14 mm
405302	2750 mm	300 mm	14 mm

## Vertical installation made possible by our NEW Hardie™ Castellated Battens

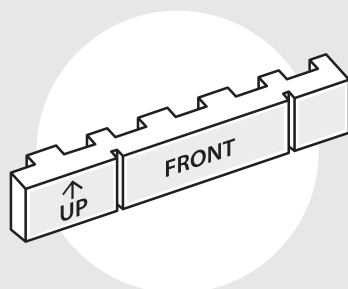

- ✓ Mix + Match panel widths for custom designs
- ✓ Moisture management allowing ventilation and drainage through cavity
- ✓ Suitable for both Hardie™ Oblique™ Cladding and Stria™ Cladding



# Endless design possibilities

From Scandi Barn to Box Modern or Mixed Cladding to Modern Farmhouse.

The beauty is in the flexibility. The two board widths offer multiple installation options and allow for an alternating rhythm or artful staggered combination. The effect is sleek, confident and contemporary.

## It's Possible™ with James Hardie.



Hardie™ Oblique™ Cladding 200mm & 300mm



Hardie™ Oblique™ Cladding 200mm & 300mm



Hardie™ Oblique™ Cladding 200mm & 300mm





Hardie™ Oblique™ Cladding 300mm



Hardie™ Oblique™ Cladding 300mm



Hardie™ Oblique™ Cladding 200mm & 300mm



# Hardie™ Oblique™ Cladding system

## REQUIRED COMPONENTS\*

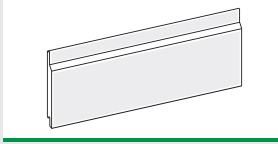

### Hardie™ Oblique™ Cladding

Factory primed 14mm profile featuring a unique bevel groove profile that creates a modern softer shadowline.

Product Codes:  
405301 4200x200mm  
405303 4200x300mm  
405300 2750x200mm  
405302 2750x300mm

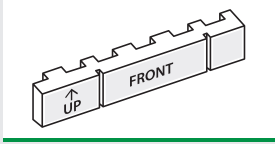

### Hardie™ Castellated Battens

A non-structural, castellated timber batten used to allow ventilation in a wall cavity.

Product Code: 306181

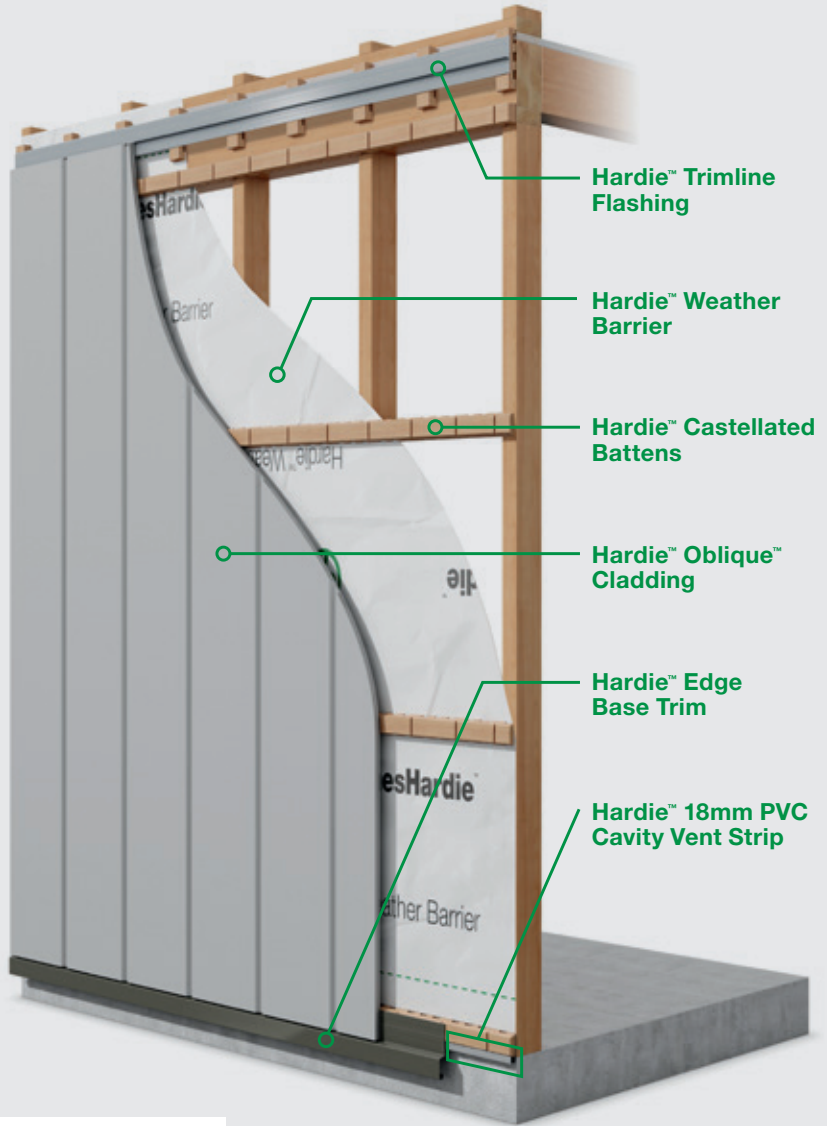

Hardie™ Trimline Flashing

Hardie™ Weather Barrier

Hardie™ Castellated Battens

Hardie™ Oblique™ Cladding

Hardie™ Edge Base Trim

Hardie™ 18mm PVC Cavity Vent Strip

## External Corners

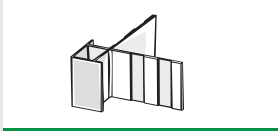

### Hardie™ 14mm Aluminium External Box Corner

A ready to paint aluminium extrusion.

Product Code: 305519

## Internal Corners

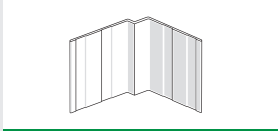

### Hardie™ 14mm Aluminium Internal Corner

A ready to paint aluminium extrusion.

Product Code: 305518

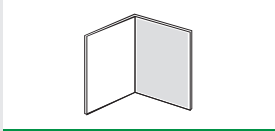

### Hardie™ 75mm Corner Flashing

Manufactured using COLORBOND® steel, used behind cladding at internal and external corners.

Product Code: 305564

## Accessories

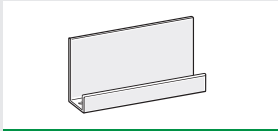

### Hardie™ 18mm PVC Cavity Vent Strip

A perforated PVC extrusion used at the bottom of walls behind cladding.

Product Code: 305555



### Hardie™ Weather Barrier

Water barrier and vapour permeable membrane.

Product Code: 305664



### Hardie™ Joint Sealant

General purpose polyurethane exterior grade joint sealant.

Product Codes:  
Cartridge 305534 / Sausage 305672



Scan here for the Hardie™ Oblique™ Cladding installation guide

## ADDITIONAL ACCESSORIES

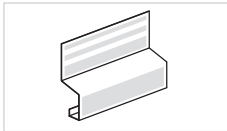

### Hardie™ Edge Base Trim

Powder coated aluminium extrusion used at slab edges.

Product Code: 305911

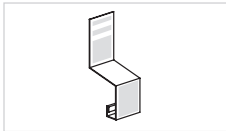

### Hardie™ Edge Base Trim Jointer

Powder coated aluminium extrusion used with Hardie™ Edge Base Trim.

Product Code: 305912

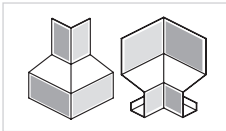

### Hardie™ Edge Corner

Powder coated aluminium extrusion used with Hardie™ Edge Base Trim at external corner junctions.

Product Codes:  
External 305914  
Internal: 305913

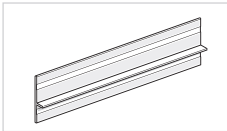

### Hardie™ Trimline Flashing

For use with Hardie™ Oblique™ Cladding behind boards at horizontal joints.

Product Code: 306128

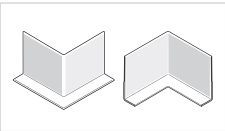

### Hardie™ Trimline External & Internal Corner Jointers

For use with Hardie™ Trimline Flashing at corner joints.

Product Codes:  
External 306130  
Internal: 306131

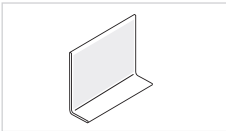

### Hardie™ Trimline Horizontal Jointer

For use with Hardie™ Trimline Flashing at horizontal joints.

Product Code: 306132



\* Note: Required components for the above scenario is based on a vertical, single-story installation build.

# 4 stages

## for fast and easy installation

Before you start installing Hardie™ Oblique™ Cladding, read the Installation Guide.

Scan here to view the Hardie™ Oblique™ Cladding installation guide



### 1 Frame preparation



1. Install your frame having a maximum noggin spacing of 900mm. All noggins must be aligned to provide continuous support to the Hardie™ Castellated Batten.

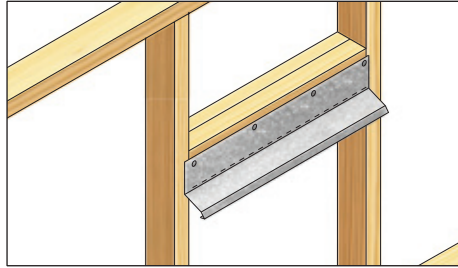

2. Install the required corrosion resistant flashings over windows and other openings.

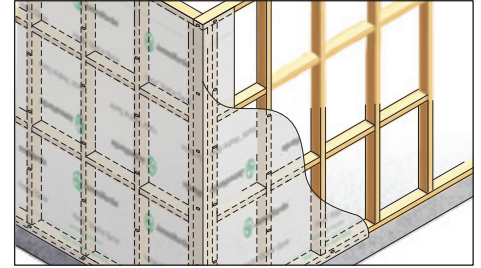

3. Install Hardie™ Weather Barrier.

### 2 Install Hardie™ Castellated Battens

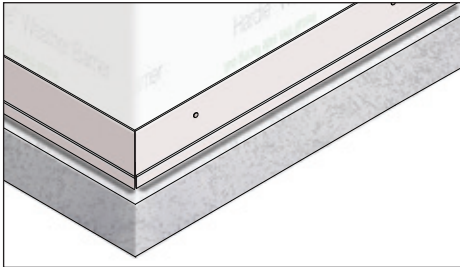

1. Install the Hardie™ PVC Vent Strip along the bottom plate.

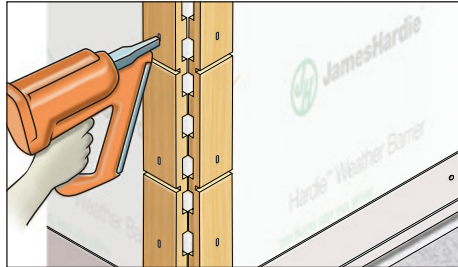

2. Install Hardie™ Castellated Battens in a vertical orientation on each side of internal and external corners.

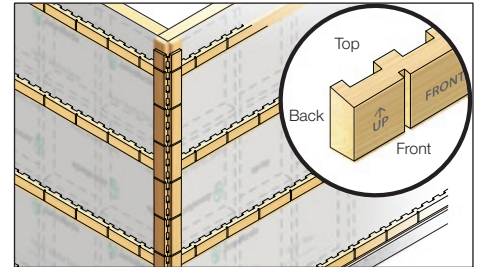

3. Install Hardie™ Castellated Battens over each noggin and top/bottom plated at max. 900mm centres.

### 3 Fix your accessories

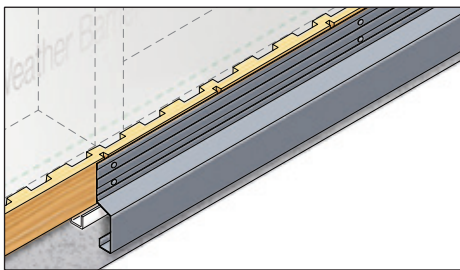

1. Install Hardie™ Edge Trim (Optional).

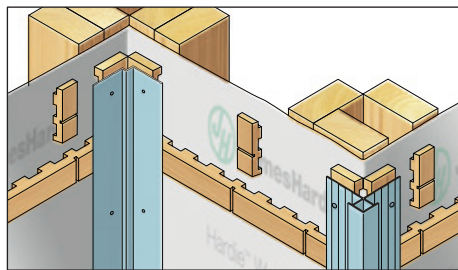

2. Install the internal and external corner accessories.

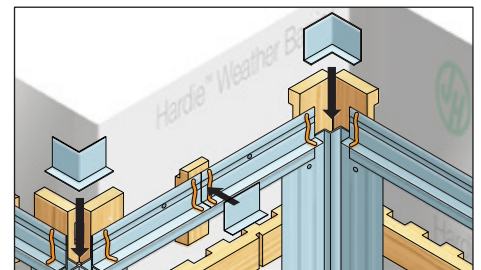

3. Install the Hardie™ Trimline Flashing followed by Hardie™ Trimline Flashing jointers.

### 4 Cladding installation

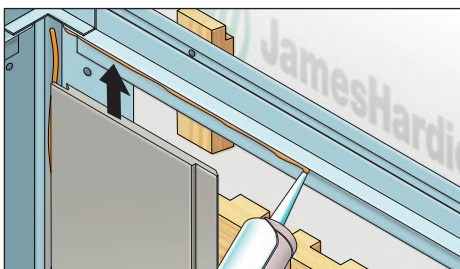

1. Apply a continuous bead of Hardie™ Joint Sealant to the underside of the Hardie™ Trimline Flashing and along the corner accessories.

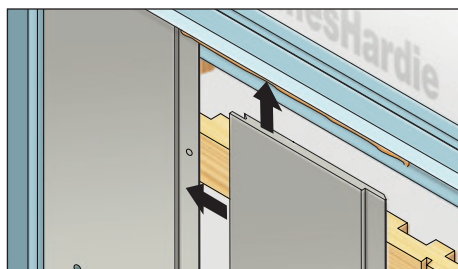

2. Push the first board against the flange and fix to the frame. Repeat the process for the remaining boards.

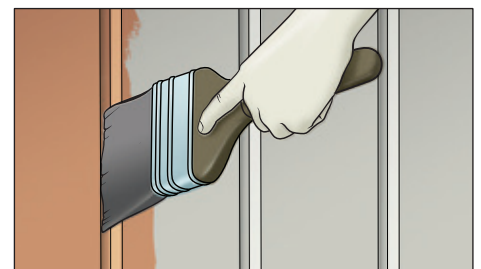

3. Paint within 3 months of installation, or within 7 days if located in a coastal area or corrosive environment.





**JamesHardie™**



For information and advice  
Call 13 11 03  
Visit [jameshardie.com.au](https://www.jameshardie.com.au)  
Scan QR code

Australia December 2022

© 2022 James Hardie Australia Pty Ltd ABN 12 084 558

™ or ® denote an unregistered trademark or registered trademark of James Hardie Technology Limited.

Colorbond® is a registered trademark of its respective owner.